

Pressure - 05/01

Automotive 3.0 bar absolute MAP sensor



Description

The APS 05 device is an automotive specification absolute pressure sensor for pressure charged engines, often known as a MAP sensor.

Each pressure sensor exploits the piezoresistive properties of silicon devices. The sensing element is a Wheatstone bridge located on a mechanically-shaped silicon chip. A thick film hybrid circuit for signal amplifying is included in the same package. The same circuitry provides thermal compensation and noise reduction.

This sensor is housed in hermetically sealed plastic protective casing



Dimensions

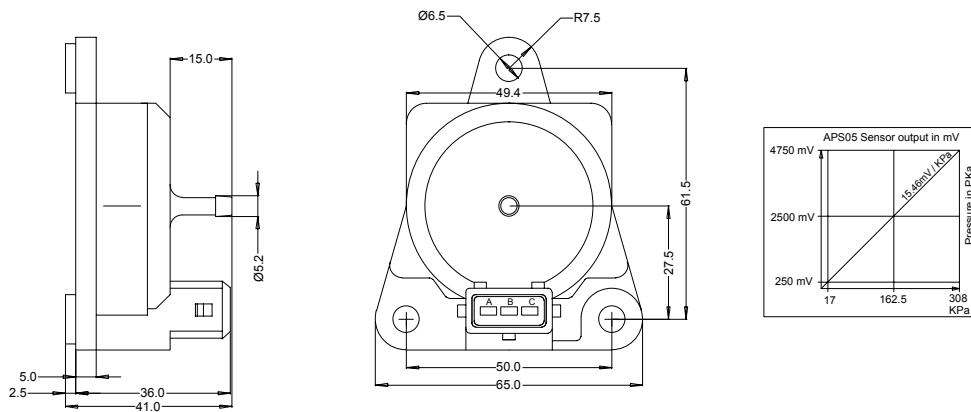

Technical Data

Mechanical Characteristics

Dimensions (maximum).....77,5x65.0x41.0 mm
 Nozzle diameter4.7 mm
 Weight.....88.0 g
 Connector.....Mini-Timer 3 way

Performance

Pressure range: 17 ÷ 308 kPa
 Operating temperature range..... -30 ÷ 110 °C
 Response time..... less than 7 ms
 Over pressure..... 05/01 450 kPa

Electrical Characteristics

Power supply.....5.00 Vdc ±0.5
 Output (min pressure) (at 5 Vdc supply)....0.25 V
 Output (Full scale) (at 5 Vdc supply)4.75 V
 Protection.....Short circuit

Electrical connection

PIN	description
A	+ 5 Vdc
B	GND
C	Signal OUT

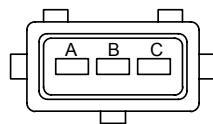

Important wiring note:

The connections A, B & C are identified as 1, 2 & 3 on many commercially available minitimer connectors and may also be numerically reversed.

Always check your loom connections against the sensor connector shown here.

Ordering information

Part No.	Description	Order Code
APS 05	Air Pressure Transducer 308 kPa (3.08 bar max)	215810001101

MM Competition Systems Ltd Hyjuniper, Long Lane Shaw, Berkshire, RG14 2TA England	For further details please contact Tel: +44 (0)8707 444666 Fax: +44 (0)8707 444888 www.mmcompsys.com mail@mmcompsys.com
---	---